

Front View of New Community Hospital

**Estimated Completion Date
November 2004**



NEW HOSPITAL FEATURES

The new hospital construction is for a 21-bed, 68,444 sq. ft. replacement facility that will cost an estimated \$24.1 million. The project is more than double the size (29,481 sq. ft.) of the existing 15-bed facility. The laboratory, Imaging, Surgery, ER, OB, and Drug room areas will all be expanded and all beds in the facility will be in private rooms. Nine of the proposed beds in the new facility will be utilized as acute care, one as psychiatric holding bed, one for CCU/telemetry holding/observation, one labor/delivery and postpartum suite and 10 beds for long-term care. The long-term care area will have its own separate entry and a group activity area, dining room, day room, and "beauty parlor." An outpatient area will provide exam rooms and treatment space for visiting physician specialists. New services planned include new nursing home beds, physical therapy, dietary and laundry.

HISTORY

Valdez community hospital is the only acute care hospital serving approximately 7,000 people living in the Valdez and Copper Center census areas. There has been an acute care hospital in Valdez since 1903. The existing facility was built in 1967 as a wing of the Harborview Developmental Center and was owned and operated by the State until 1975, when the Hospital wing was leased to the City of Valdez. Harborview closed in 1997, leaving the Hospital attached to a vacant, deteriorating building. The existing facility has numerous life and safety code violations, does not ADA requirements and space for ancillary services is not adequate.

In 2000, Valdez Hospital was the first hospital in Alaska to receive designation as a critical access hospital (CAH). CAH designation is a Federal initiative through the Rural Hospital Flexibility Program to provide funding to State Governments to strengthen rural hospitals and allow rural communities to preserve access to primary care and emergency health care services and help assure the financial viability of rural facilities. Critical Access Hospital designation indicates the necessity of offering services in a geographic area that does not have appropriate access to care.

Questions Please call 835-2249

Layout of the New Valdez Community Hospital

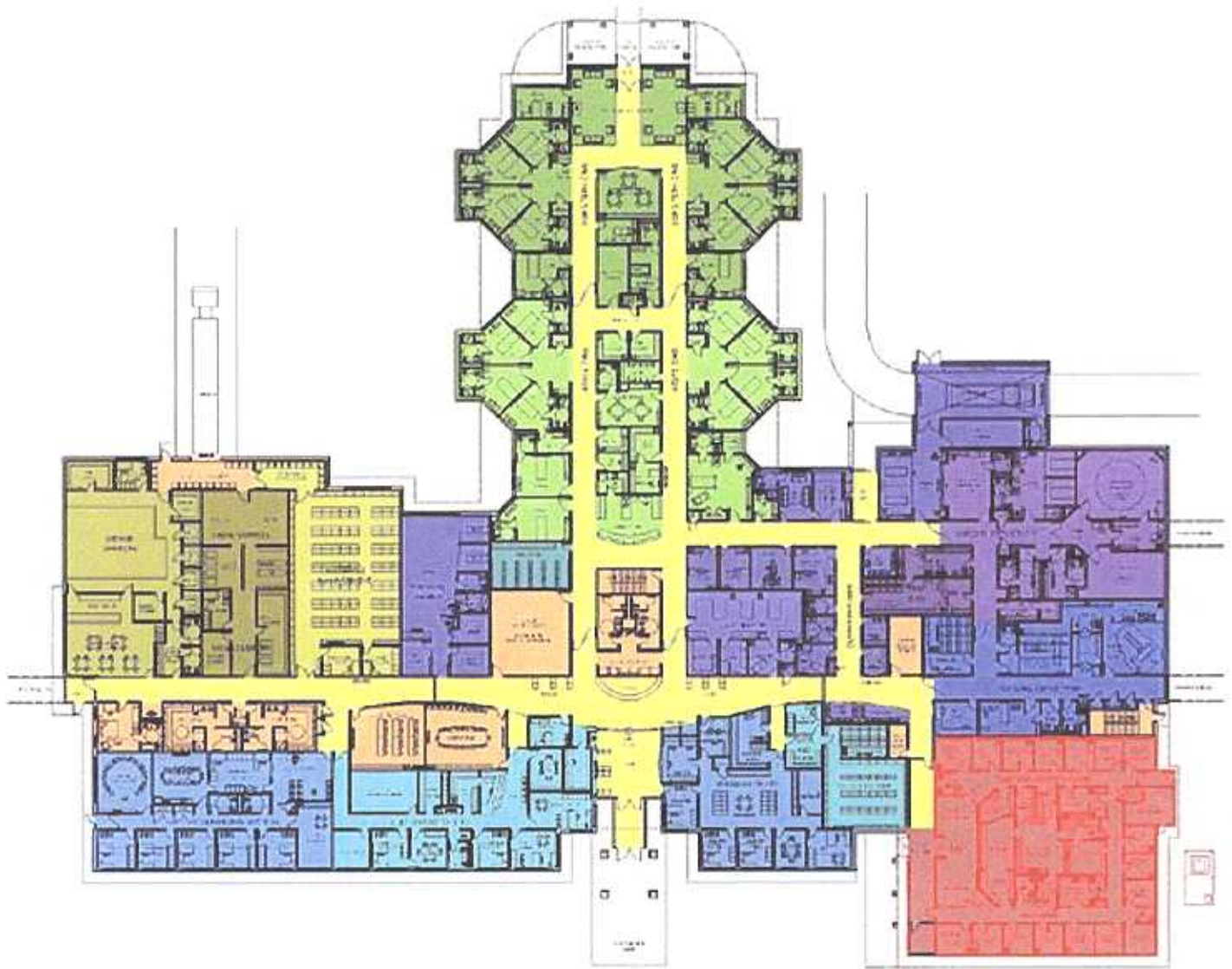

Partial View of the New Valdez Community Hospital

